

Covid-19 Testing in Care Homes



Dear Colleagues,

I am writing to advise you of the new process which has been agreed Board wide for testing of suspected Covid-19 cases in the care home setting from Thursday 30th April 2020.

Each HSCP will have a central point where tests will originate and these will be triggered by a SCI gateway referral from the patients GP following a telephone clinical assessment. The referral does not require any clinical information. When requesting the test the GP will also have to make an ICE request on order comms .

The local centres will then print off labels and arrange the test to be delivered to Nursing Homes or for the testing team to visit Residential Care Homes. Where tests are carried out these will be collected by the local centre and should not be returned to the GP practice.

Initially there will be no testing scheduled at the weekend as it is not time critical. Test should only be carried out from day 2-5 of the illness, however, referral may be made from day 1. Care homes will be asked to contact the resident's GP on Monday morning to discuss the symptoms and for testing to be arranged if appropriate for residents who develop symptoms over the weekend.

Enclosed please find the local pathway for information as well as SCI Gateway and ICE information on how to refer for and request testing. Please also note the ICE request may only be used for care home residents.

Yours sincerely,

David Leese

Chief Officer

Renfrewshire HSCP

On behalf of the NHSGGC COVID Primary Care Clinical Advisory Group

Test Info1
(process)

GG&C Covid-19 Care Home Test Process

29/04/20

Care/Nursing Home Patient has symptoms (day 1-5) of COVID-19
(New, continuous cough
+/- Fever >37.8)
OR
New Admission from Community



WEEKENDS – new requests should be reported the next working day to the GP Practice.

MONDAY to FRIDAY
8am to 6pm

Contact GP

GP approves Covid-19 test

GP orders test on Order Comms &
SCI Gateway

Care Home Test Coordination
Base (CH/TCB)
Admin staff prepare and label sample



Sample kit
Delivered to
Nursing Home
(pre-labeled)

Testing Staff
requested to
visit Care
Home

Nursing Home
Staff collect
sample from
patient

Testing Staff
visit Care
Home &
sample taken
from patient

Sample transported to Care/Nursing
Home Testing Collection Point



Sample to Lab



Result returns to GP workflow



GP Practice communicates
results and advises any actions



Care Home Test Coordination Bases (CH/TCB) By HSCP

Glasgow City 0141 531 9204

East Dunbartonshire 0141 232 8214

Renfrewshire 01505 821409

West Dunbartonshire 0141 531 6328

Inverclyde 01475 506004

East Renfrewshire 0141 451 0505

Notes

- Covid19 test must be able to be completed during day 2-5 of the illness.
- All new admissions to Care Homes require barrier nursing for 14 days.
- Tests most use in detecting first cases in home. Then all symptomatic patients need to be barrier nursed for 7 days. Subsequent testing is less useful but may be desirable.
- If necessary, samples can be held overnight.
- Test can only be done for Care/Nursing Home patient when approved/requested by GP.

Testing Kit Needed per patient

- 1 x swab
- 1 x labelled combined viral nose and throat medium
- 1 x tongue depressor
- 1 x clear specimen bag

How the test is done

<https://www.hps.scot.nhs.uk/web-resources-container/covid-19-obtaining-an-upper-respiratory-tract-diagnostic-sample/>

How to package samples

<https://www.hps.scot.nhs.uk/web-resources-container/covid-19-packaging-of-diagnostic-samples-for-onward-transportation/>

Care & Nursing Home COVID Test Protocol (vR20.5)

This is an example of the SCI Gateway referral

Key Messages Tab:

Key Messages	Clinical Data	Past Medical / Family History	Medication	Risks/Alerts	Demographics	Referral	Additional Support Needs
Care & Nursing Home COVID Test Protocol (vR20.5)							

Key Messages



This is a referral for the Care Home or Nursing Home patient to be tested for COVID-19 by the local HSCP Testing Team or Nursing Home staff.

A postponed GP Order Comms request must be completed for the patient within the ICE application to allow the team to generate the label for the sample and to ensure that the result is returned to the practice.

Clinical Data Tab:

Key Messages	Clinical Data	Past Medical / Family History	Medication	Risks/Alerts	Demographics	Referral	Additional Support Needs
Care & Nursing Home COVID Test Protocol (vR20.5)							

Clinical Data

Main Presenting Complaint	
Main Presenting Complaint (maximum of 98 characters)	
Provisional Diagnosis / Presenting Complaint*	Referral for Covid-19 Test <input type="checkbox"/> 
What is the question you are looking to be answered by sending this patient for assessment?	
Additional free-text Information	Care & Nursing Home COVID Test Protocol 23/04/20 
Priority Reason	
Please Select priority and enter a priority reason if applicable	
Priority*	Urgent <input type="checkbox"/>
Priority Reason	<input type="text"/>
Date of Onset	<input type="text"/> 
Unique Care Pathway Number*	1ZZ004641845K

NOTES The SCI gateway referral can be created as a “null referral” ie no additional information needs to be added.

Remember - ORDER COMMS test request (postponed ie to be done later) needs to be created to allow Testing Staff to create labels and get the result back to GP Practice.

NHS Greater Glasgow and Clyde

GPs – Process for Placing Postponed COVID-19 Requests



The COVID-19 item can be found in the Virology section of the **Common Requests** screen

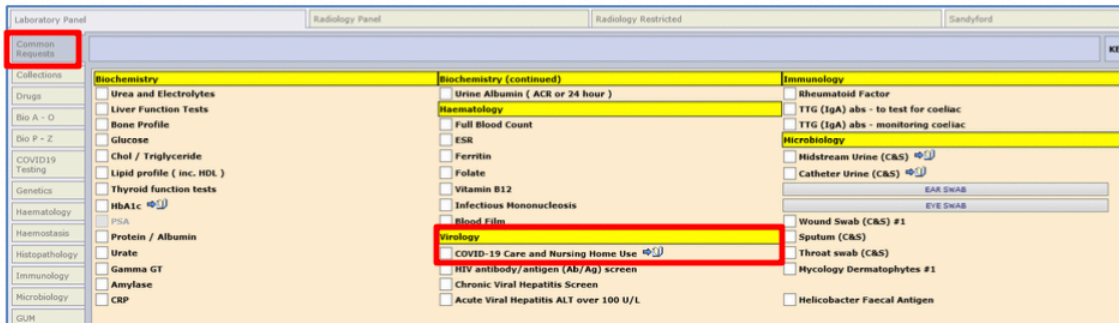

Specimens must be postponed to allow the HSCP Testing Staff to complete the request.

If your patient doesn't have a CHI recorded on your Practice System you must also provide the Patient ID that the ICE request was placed with as part of the SCI Gateway Referral. This will ensure that the HSCP Testing Staff can quickly find the request on ICE. There will be no **CHI Number** in the ICE Patient Banner for these patients:-

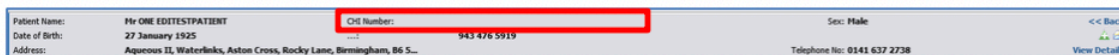

The easiest way to find the Patient ID is to print the **Postponed Order Summary** when you postpone the request.

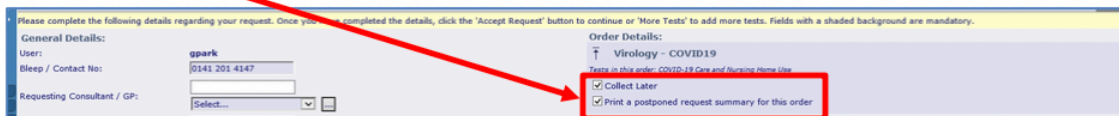

You can print this to PDF to save paper as you only need it to confirm the Patient ID

The Patient ID will be recorded against the **CHI Number** field on the Postponed Order Summary Report

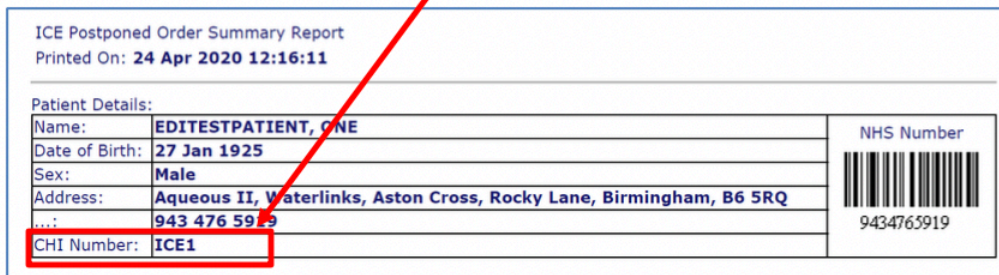

Record the Patient ID in the Additional free-text Information section of the SCI Gateway Referral

